

1711ES & 1712ES SERIES COUPLERS

OPW Transport Series Dry Disconnect Couplings are used on multi-compartment petroleum, solvent and chemical product delivery trucks with an on-board pumping unit.

Benefits

- **Spill Protection** – Helps to reduce the hazard potential of spilled liquid during the connection/disconnection process. Special automatic shut-off design minimizes product loss in the event of an accidental disconnection.
- **Ease Of Use** – The built-in elbow/swivel design provides freedom of movement when used with a hose on tank trucks.

Features

- **Built-In Elbow/Swivel** – Provides freedom of movement when used with a hose on tank trucks.
- **Swivel** - 2" female NPT.
- **Poppeted Adaptor and Coupler** – Closes both ends of process during routine disconnect.
- **Built-In Valve** – For reliability of functionality. No additional valves required.
- **Quick Disconnect Cam and Groove Design** – Provides for smooth, easy connection/disconnection action.
- **360° Orientation** – The coupling can be connected in any orientation onto the adaptor.
- **Automatic Shut-Off Device** – Minimizes product loss in the event of accidental disconnection.
- **Lever Actuation** – For easy open/closing.
- **Manufactured in compliance with the highest quality standards of design, material, and construction.**
- **Available in Aluminum Plated Steel Internals with Buna-N Seals or Viton®.**

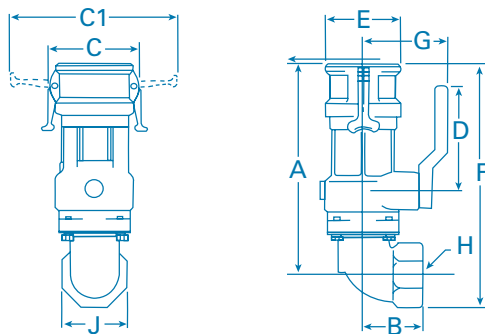

Dimensions

SIZE IN INCHES (Nominal)	2"
A Top of Body to Centerline of Elbow	9-9/16"
B Centerline of Elbow to End of Elbow	2-3/4"
C Distance across Cam Arms when closed	4-3/8"
C1 Distance across Cam Arms when open	8"
D Centerline of Stem to end of Lever	4-5/8"
E Diameter of Coupler End	3-33/64"
F Length of Unit	11-3/16"
G Centerline of Coupler to outside of Lever	3-5/8"
H Pipe Thread (NPT)	2"
J Distance across Flats of Octagon	3"

Ordering Specifications

PRODUCT NO.	PRODUCT	SIZE	CONSTRUCTION	SEALS
1711ES-0200	90° Elbow/Swivel Coupler	2"	Aluminum, Acetal	Buna-N
1712ES-0200	90° Elbow/Swivel Coupler	2"	Aluminum, Acetal	Viton®