

MATERIAL:
ALUMINUM (2" 3" 4" 6")

OPW Engineered Systems

STYLE 40FJ SWIVEL JOINT-CAST

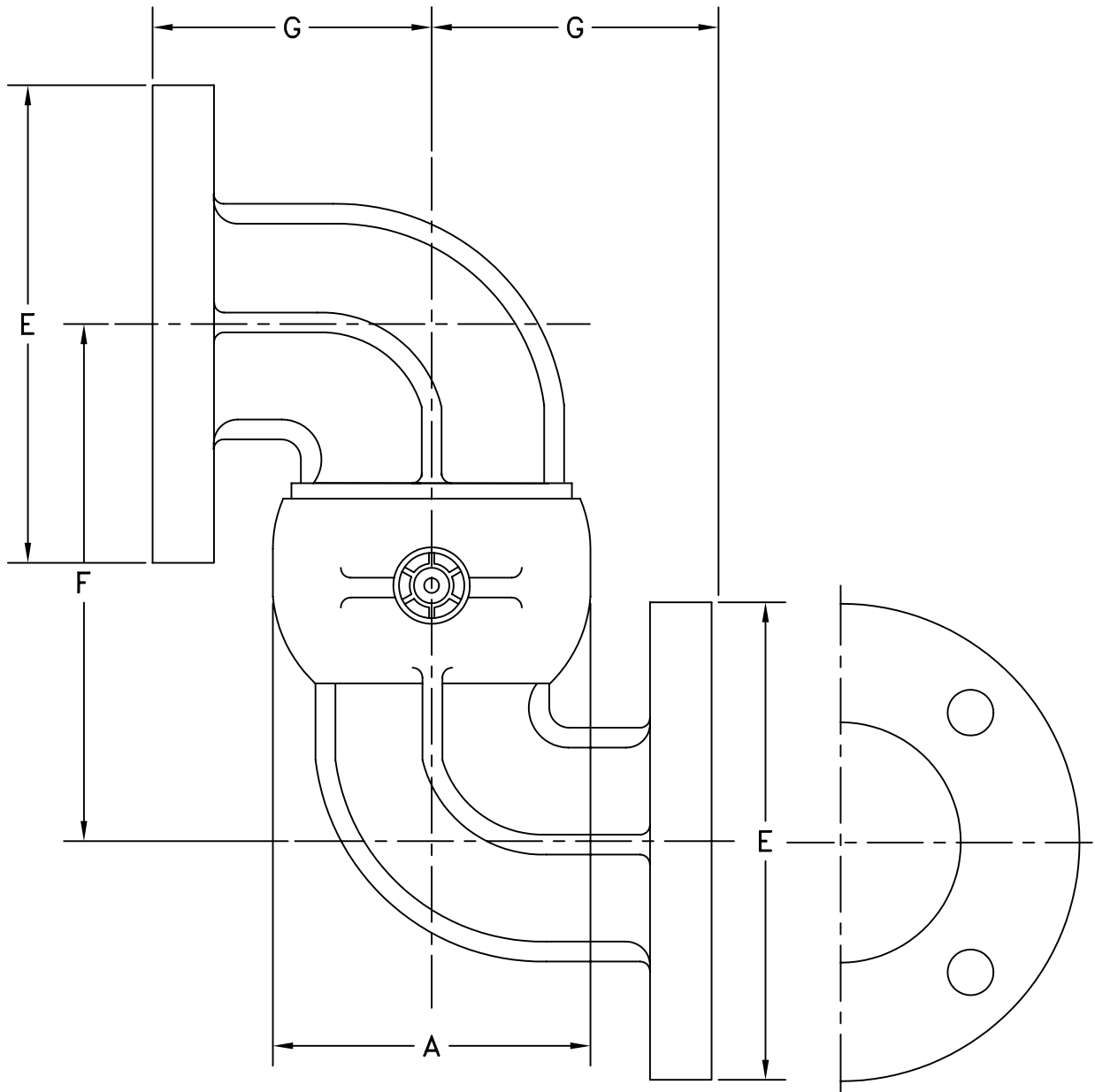

SIZE	2"	3"	4"	6"
A	3-3/4"	4-7/8"	6-1/16"	9-1/8"
E	6"	7-1/2"	9"	11"
F	6-1/8"	7-5/8"	9-1/4"	14-1/8"
G	5-1/2"	5"	6-1/16"	7-3/4"
∅ BOLT CIRCLE	6"	6"	7-1/2"	9-1/2"
NO. BOLTS - ∅	(4) 5/8"	(4) 5/8"	(8) 5/8"	(8) 3/4"